

01/2019

# Mod: **SLID-18-R2**

**Production code: 06.03.0.BR.50.2.F.230.50 (550 CHV/VCI)**



**Diamond**  
catering equipment

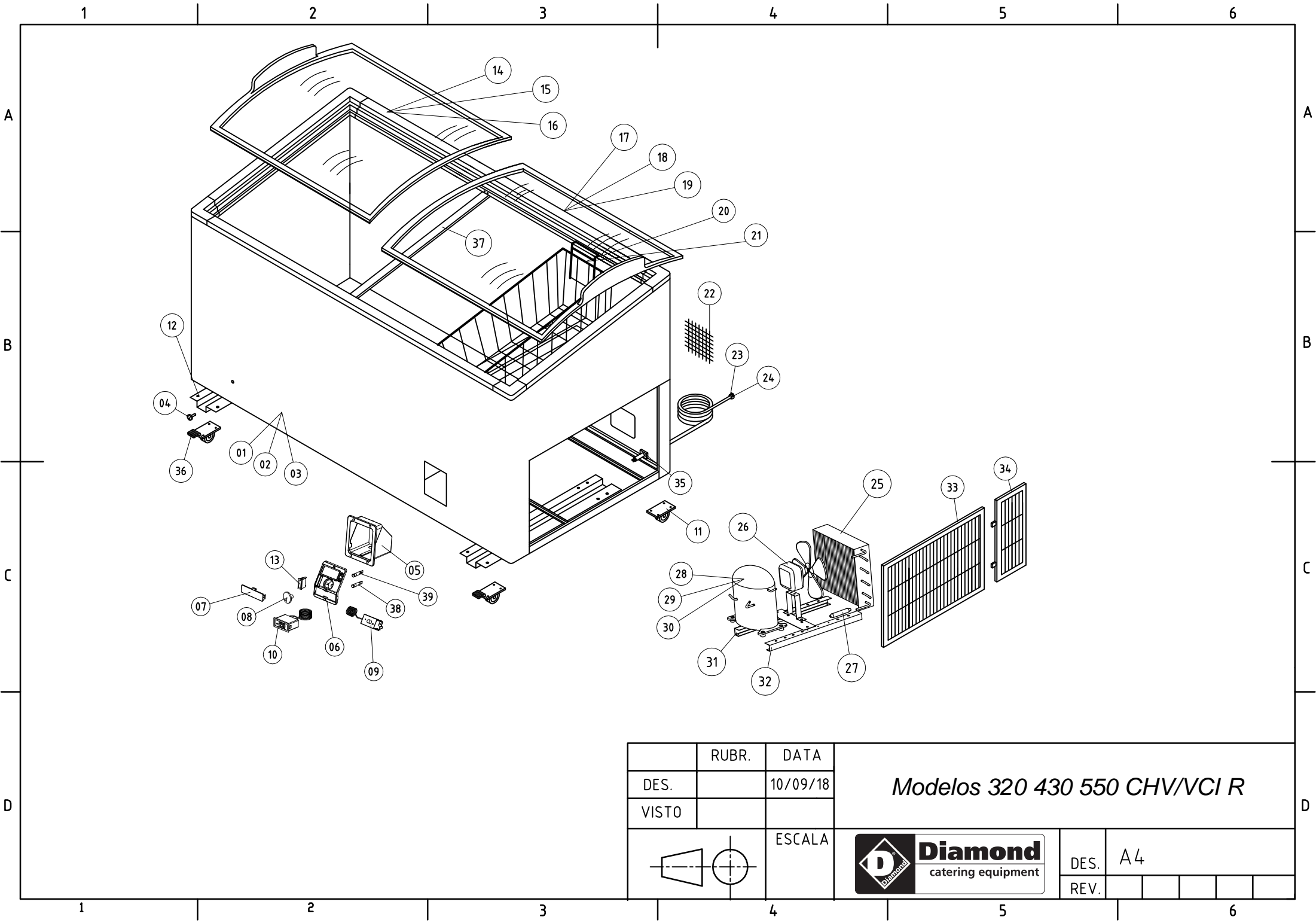

|       | RUBR. | DATA     |
|-------|-------|----------|
| DES.  |       | 10/09/18 |
| VISTO |       |          |

*Modelos 320 430 550 CHV/VCI R*

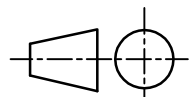

ESCALA



|      |    |  |  |  |  |
|------|----|--|--|--|--|
| DES. | A4 |  |  |  |  |
| REV. |    |  |  |  |  |

## DESENHO EXPLODIDO / EXPLODED DRAW

| PEÇA Nº<br>ITEM NO. | DESIGNAÇÃO / DESIGNATION                                     | QUANT. PEÇAS<br>PIECES QUANT. | CHV/VCIR |     |     | CÓDIGO<br>CODE | € / UN |
|---------------------|--|-------------------------------|----------|-----|-----|----------------|--------|
|                     |  |                               | 320      | 430 | 550 |                |        |
| 1                   | CUBA / TANK  | 1                             | •        |     |     | PI015          |        |
| 2                   | CUBA / TANK  | 1                             |          | •   |     | PI020          |        |
| 3                   | CUBA / TANK  | 1                             |          |     | •   | PI025          |        |
| 4                   | TAMPA DE ESGOTO / EXTERNAL DRAIN PLUG                        | 1                             | •        | •   | •   | PL160          |        |
| 5                   | CAIXA DO PAINEL DE COMANDO / CONTROL PANEL BOX               | 1                             | •        | •   | •   | PL118          |        |
| 6                   | PAINEL DE COMANDO / CONTROL PANEL                            | 1                             | •        | •   | •   | PL123          |        |
| 7                   | PLACA DE MARCA / BRAND PLATE                                 | 1                             | •        | •   | •   | PL109          |        |
| 8                   | BOTÃO TERMOSTATO / THERMOSTAT KNOB                           | 1                             | •        | •   | •   | PL040          |        |
| 9                   | TERMOSTATO / THERMOSTAT                                      | 1                             | •        | •   | •   | ME521          |        |
| 10                  | TERMÓMETRO / THERMOMETER                                     | 1                             | •        | •   | •   | DV390          |        |
| 11                  | RODÍZIOS GIRATÓRIOS / TWIN WHEEL SWIVEL CASTOR WITHOUT BREAK | 2                             | •        | •   | •   | DV311          |        |
| 12                  | SUORTE DOS RODÍZIOS / CASTORS SUPPORT                        | 2                             | •        | •   | •   | PI603          |        |
| 13                  | CAIXA F11.400 COM 3 TERMINAIS / BOX F11.400 WITH 3 TERMINALS | 1                             | •        | •   | •   | ME415          |        |
| 14                  | TAMPA VIDRO INFERIOR / LOWER SLIDING LID                     | 1                             | •        |     |     | TV027          |        |
| 15                  | TAMPA VIDRO INFERIOR / LOWER SLIDING LID                     | 1                             |          | •   |     | TV037          |        |
| 16                  | TAMPA VIDRO INFERIOR / LOWER SLIDING LID                     | 1                             |          |     | •   | TV047          |        |
| 17                  | TAMPA VIDRO SUPERIOR / UPPER SLIDING LID                     | 1                             | •        |     |     | TV025          |        |
| 18                  | TAMPA VIDRO SUPERIOR / UPPER SLIDING LID                     | 1                             |          | •   |     | TV035          |        |
| 19                  | TAMPA VIDRO SUPERIOR / UPPER SLIDING LID                     | 1                             |          |     | •   | TV045          |        |
| 20                  | CESTO / BASKET   | 4                             | •        | •   |     | AR045          |        |
| 21                  | CESTO / BASKET   | 6                             |          |     | •   | AR045          |        |
| 22                  | GRELHA ARAME / WIRE GRID                                     | 1                             | •        | •   | •   | AR100          |        |
| 23                  | CABO DE ALIMENTAÇÃO INGLÊS / UK POWER CORD                   | 1                             | •        | •   | •   | ME015          |        |
| 24                  | CABO DE ALIMENTAÇÃO EUROPEU / EURO POWER CORD                | 1                             | •        | •   | •   | ME010          |        |
| 25                  | CONDENSADOR / CONDENSER                                      | 1                             | •        | •   | •   | CC020          |        |
| 26                  | MOTOVENTILADOR / FAN MOTOR + BLADE                           | 1                             | •        | •   | •   | ME430          |        |
| 27                  | FILTRO / FILTER  | 1                             | •        | •   | •   | CC090          |        |
| 28                  | COMPRESSOR NUT55Cab  | 1                             | •        |     |     | ME183          |        |
| 29                  | COMPRESSOR NUT55Cab  | 1                             |          | •   |     | ME183          |        |
| 30                  | COMPRESSOR NUT60Cab  | 1                             |          |     | •   | ME184          |        |
| 31                  | APOIO DO COMPRESSOR (ESQ) / LEFT COMPRESSOR SUPPORT          | 1                             | •        | •   | •   | PI630          |        |
| 32                  | APOIO DO COMPRESSOR (DIR) / RIGHT COMPRESSOR SUPPORT         | 1                             | •        | •   | •   | PI640          |        |
| 33                  | GRELHA PLÁSTICA GRANDE / BIG PLASTIC GRID                    | 1                             | •        | •   | •   | PL066          |        |
| 34                  | GRELHA PLÁSTICA PEQUENA / SMALL PLASTIC GRID                 | 1                             | •        | •   | •   | PL067          |        |
| 35                  | CERRA CABOS / CABLES BUSHING                                 | 1                             | •        | •   | •   | DV040          |        |
| 36                  | RODÍZIOS GIRATÓRIOS / TWIN WHEEL SWIVEL CASTOR WITH BREAK    | 2                             | •        | •   | •   | DV312          |        |
| 37                  | TIRANTE / CROSS BAR  | 1                             | •        | •   | •   |                |        |
| 38                  | SINALIZADOR VERDE / GREEN SIGNAL                             | 1                             | •        | •   | •   | ME456          |        |
| 39                  | SINALIZADOR VERMELHO / RED SIGNAL                            | 1                             | •        | •   | •   | ME466          |        |