

07/2018

Mod: SR2/R6

Production code: 39130621000 / GP20I



Diamond
catering equipment



PT920-I Pizza Counter GN1/1

Product features:

- Stainless steel 304
- Granite table top
- Cooling well for GN1/6 pans
- Fan assisted cooling
- Automatic defrost
- 2 doors
- Adjustable feet



GN1/6 refrigerated cooling well



Drawers as option

Technical data

Climate Class	4
Temperature Range, °C	2 to 10
Gross Volume, l.	260
Net. Volume, l.	230
External Dimensions, WxDxH	900x700x(1080-1100)
Internal Dimensions, WxDxH	830x515x500
Packing Dimensions, WxDxH	980x770x1250
40'ft Container load, pcs.	72
Doors	2 hinged solid
Shelves	2, GN1/1
Exterior	SS304
Interior	SS304
Castors/Feet	4 adjustable feet
Lock	No
Voltage/Frequency, V/Hz.	220-240/50
Rated Input Power, W.	155
Energy Consumption. kWh/24h.	2.2
Gross Weight, kg.	115
Net. Weight, kg.	103
Noise Level, db(A)	42
Type of Cooling	Fan assisted
Type of Defrost	Automatic
Type of Control	Electronic
Thermometer	Yes
Refrigerant	R600a
Charge, g.	68

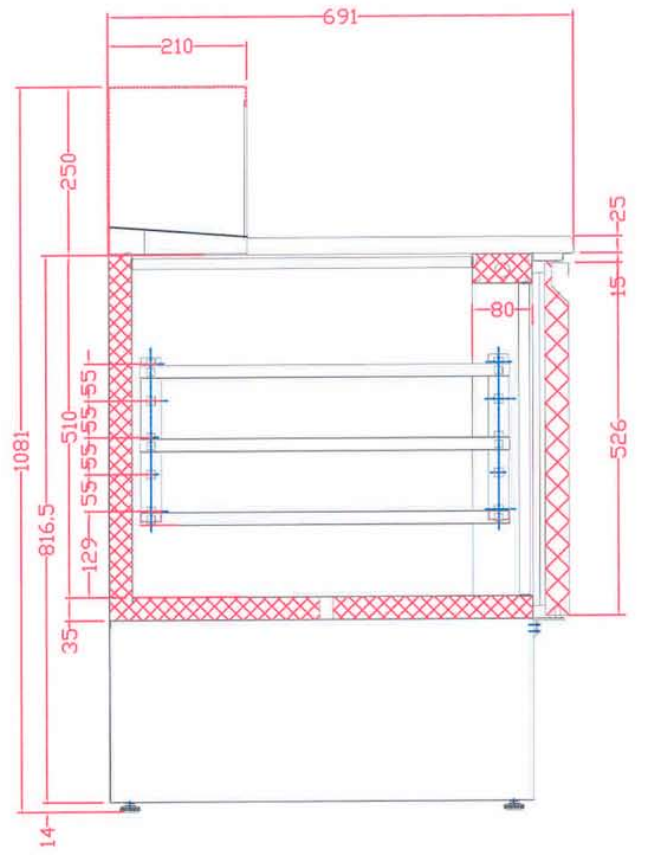
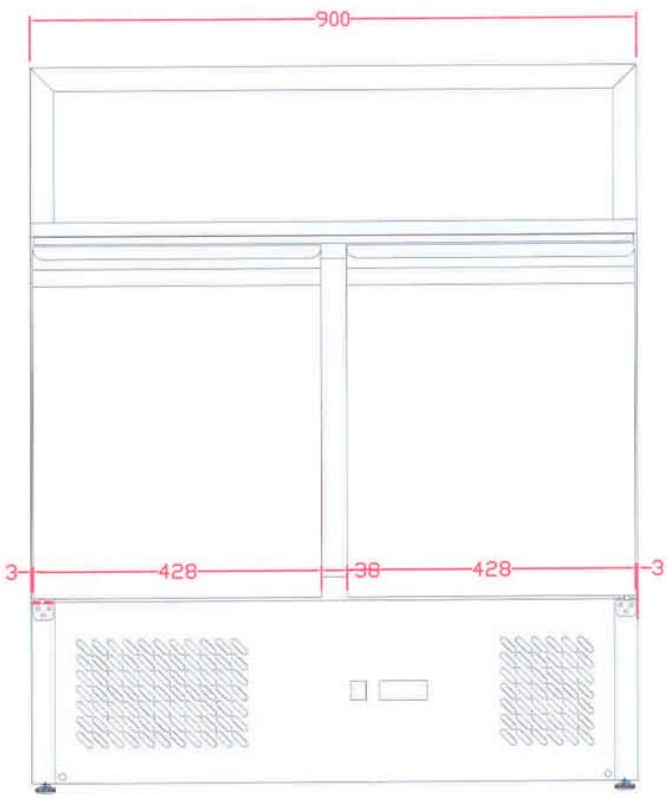

Size of GN-Pans.

