

**MOD : ID140/R9G**

**Production code : 19102737**

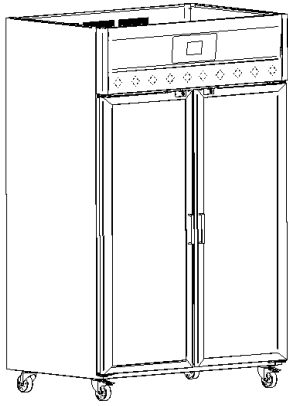

**Specific model**

ID140/R9G C 230V 1N 50Hz

19102737

09/2023

**DIMENSIONS**

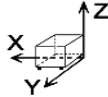

X Width	1358 mm	X Gross width	1430 mm
Y Depth	856 mm	Y Gross depth	880 mm
Z Height	2145 mm	Z Gross height	2185 mm
Net Weight	227,0 kg	Gross Weight	240,0 kg
Net volume	2,371 m3	Gross volume	2,750 m3

**ELECTRICITY TECHNICAL SPECIFICATIONS**

Electric power	0,206 kW
Amperage (A)	1 A
Voltage	230V - 1N
Electric frequency	50Hz

**GAS TECHNICAL SPECIFICATIONS**

Gas type	R-600a
----------	--------

**COLD TECHNICAL SPECIFICATIONS**

Climate class	3
Cooling gas load	100,000 g
Refrigeration power	0,436 kW
Clasif. Energy efficiency	C
Energy Efficiency Index	20,01 %
Annual elec. consumption	1510 kWh
Model Type	Vertical cabinet
Power consumption 24h	4,14 kWh
Gross internal volume	1332 L
Refrigeration net.vol	955 L

**CONNECTIONS TECHNICAL SPECIFICATIONS**

Single-phase 230V wiring	2X1+T-2A
--------------------------	----------

**OTHERS**

Noise level	53,00 dB
Condensation system	Vent.

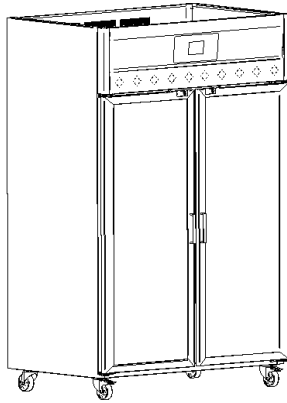
**Specific model**

ID140/R9G C 230V 1N 50Hz

19102737

09/2023

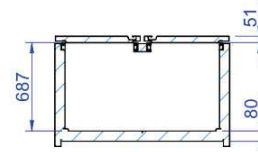
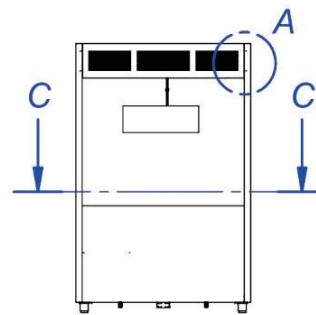
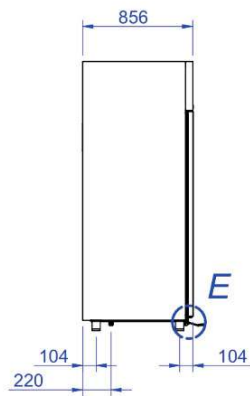
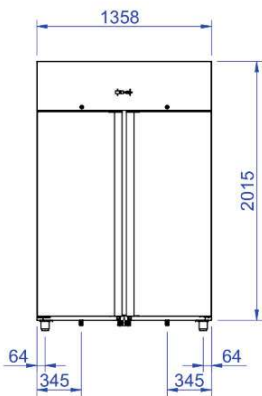

SECTION C-C

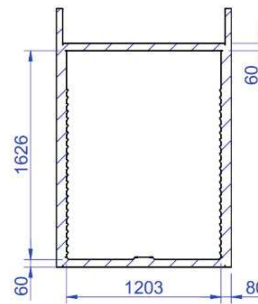
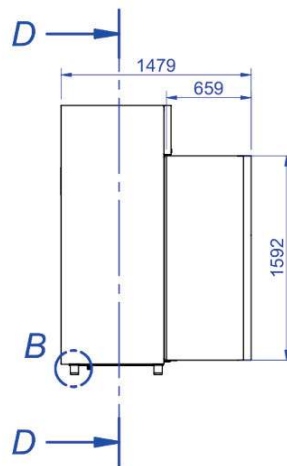

SECTION D-D

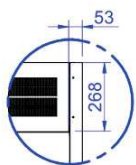
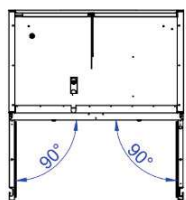
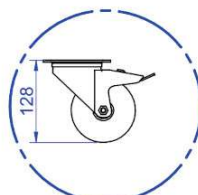
 A  
ELECT.

"R" OPTION

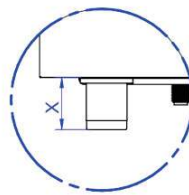

80 &lt; X &lt; 115

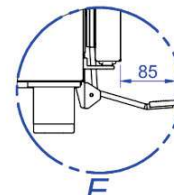
 E  
"PD" OPTION